

Part number

**MHV 24.32**

Hood, C-TYPE series, with 4 pegs, M32 top cable entry, size "104.27"

Product description		Material properties	
Product type	Hood	Colour	RAL 7040 grey
Series	C-TYPE	RoHs conformity	Compliant
Closing type	With 4 pegs	China RoHs - EFUP	E
Size	Size 104.27	REACH SVHC substances	No
Cable entry	Top cable entry M32	Approvals / Standards	
Technical data		Certifications	DNV, BV
IP degree of protection	IP65 / IP66 / IP69	UL	ECBT2
Further technical details		cUL	ECBT8
Weight	192,00 g	General ordering information	
Operating temperature range (min, max)	-40°C...+125°C	EAN13 code	8015747056168
		eCl@ss 8.1	27440202
		ETIM 7.0	EC000437
		Packaging Information	
		Packaging length	305,00 mm
		Packaging height	180,00 mm
		Packaging width	275,00 mm
		Packaging weight	3,94 kg
		Packaging volume	15,10 dm³
		Packaging description	Carton box
		Packaging quantity	20 Pcs
		Packaging EAN code	8015747056175
		Sub-packaging weight	0,99 kg
		Sub-packaging description	Plastic packaging
		Sub-packaging quantity	5 Pcs
		Sub-packaging EAN barcode	8015747056182

Part number

**MHV 24.32**

Catalogue drawings

**CHO [CAO] CHV (CAV) - MHO [MAO]  
MHV (MAV)**

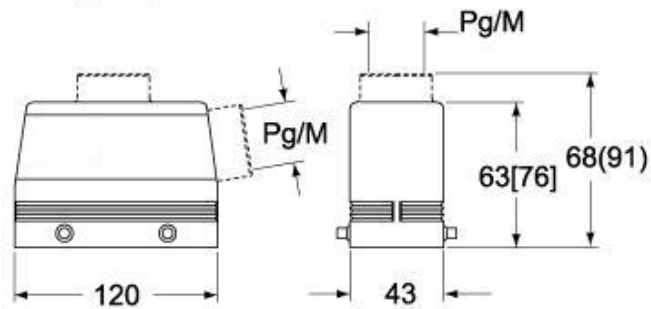

**CHV G (CAV G) - MHV G (MAV G) - [MFV G]**

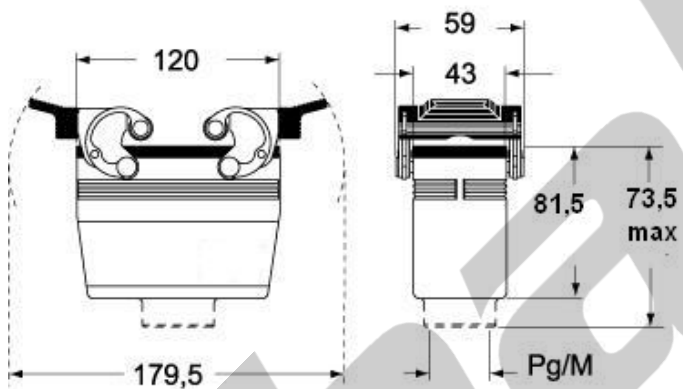

## Notes

Dimensions shown in mm are not binding and may be changed without notice.