

Part number

**CHI 06 L**

Bulkhead mounting housing, C-TYPE series,  
with 1 lever, size "44.27"

Product description		Material properties	
<b>Product type</b>	Bulkhead mounting housing	<b>Other materials</b>	Lever: Stainless steel, polyamide (PA)
<b>Series</b>	C-TYPE		Gasket: NBR
<b>Closing type</b>	With 1 lever	<b>Colour</b>	RAL 7040 grey
<b>Size</b>	Size 44.27	<b>RoHs conformity</b>	Compliant
<b>Cable entry</b>	Without cable entry	<b>China RoHs - EFUP</b>	E
Technical data		<b>REACH SVHC substances</b>	No
<b>IP degree of protection</b>	IP65 / IP66 / IP69	<b>Approvals / Standards</b>	
Further technical details		<b>Certifications</b>	DNV, BV
<b>Weight</b>	106,00 g	<b>UL</b>	ECBT2
<b>Operating temperature range (min, max)</b>	-40°C...+125°C	<b>cUL</b>	ECBT8
		General ordering information	
		<b>EAN13 code</b>	8015747017138
		<b>eCl@ss 8.1</b>	27440202
		<b>ETIM 7.0</b>	EC000437
		Packaging Information	
		<b>Packaging length</b>	420,00 mm
		<b>Packaging height</b>	230,00 mm
		<b>Packaging width</b>	315,00 mm
		<b>Packaging weight</b>	5,04 kg
		<b>Packaging volume</b>	30,43 dm <sup>3</sup>
		<b>Packaging description</b>	Carton box
		<b>Packaging quantity</b>	40 Pcs
		<b>Packaging EAN code</b>	8015747017145
		<b>Sub-packaging weight</b>	0,63 kg
		<b>Sub-packaging description</b>	Plastic packaging
		<b>Sub-packaging quantity</b>	5 Pcs
		<b>Sub-packaging EAN barcode</b>	8015747017152

Part number

**CHI 06 L**

Catalogue drawings

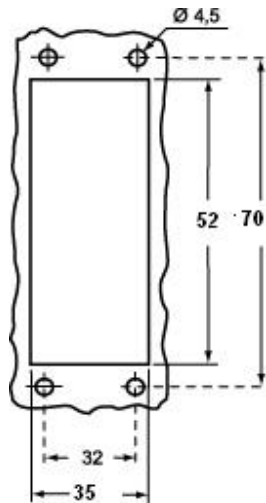

Catalogue drawings

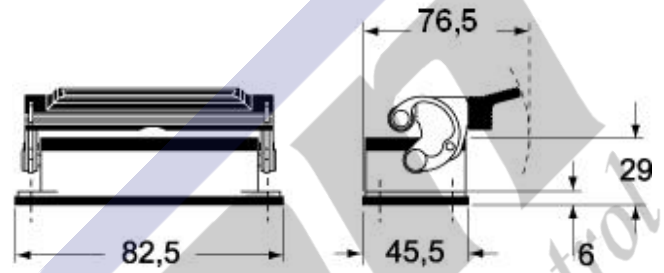
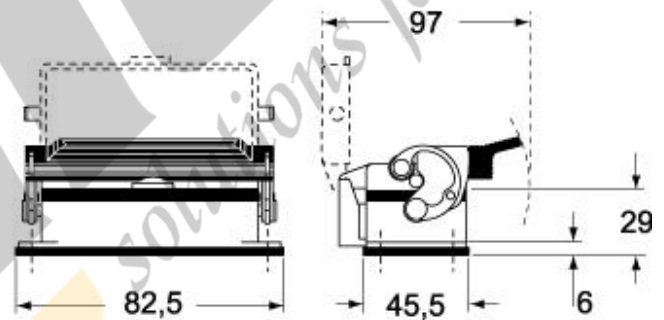
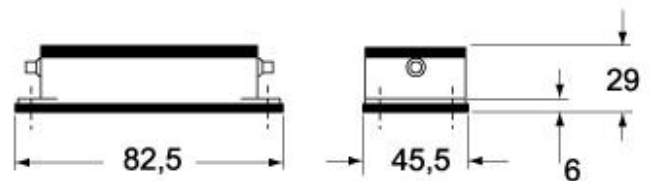
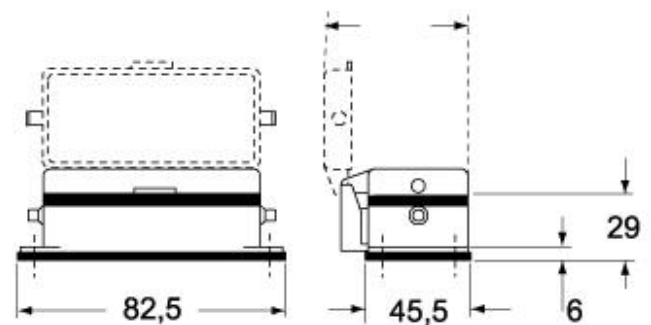
**CHI L****CHI LS****CHI LC****CHI LCS/LCP**

---

## Notes

Dimensions shown in mm are not binding and may be changed without notice.

---

